

## Spare parts ACTUSMART CM03.V1.2

### 1 Standard version

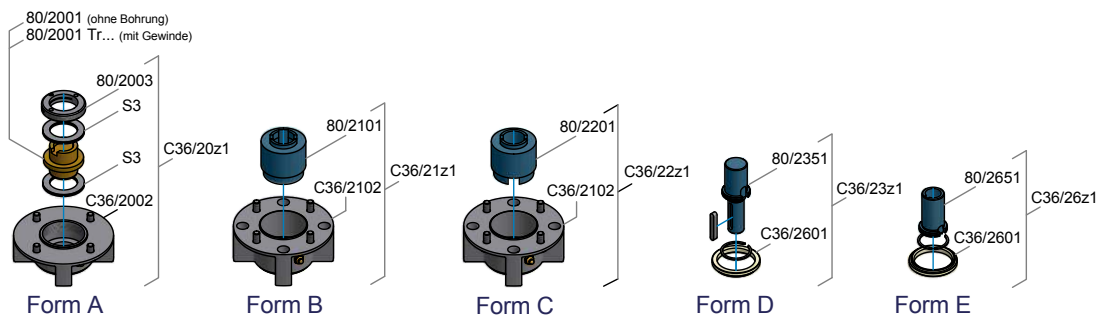

## 2 Explosion-proof version

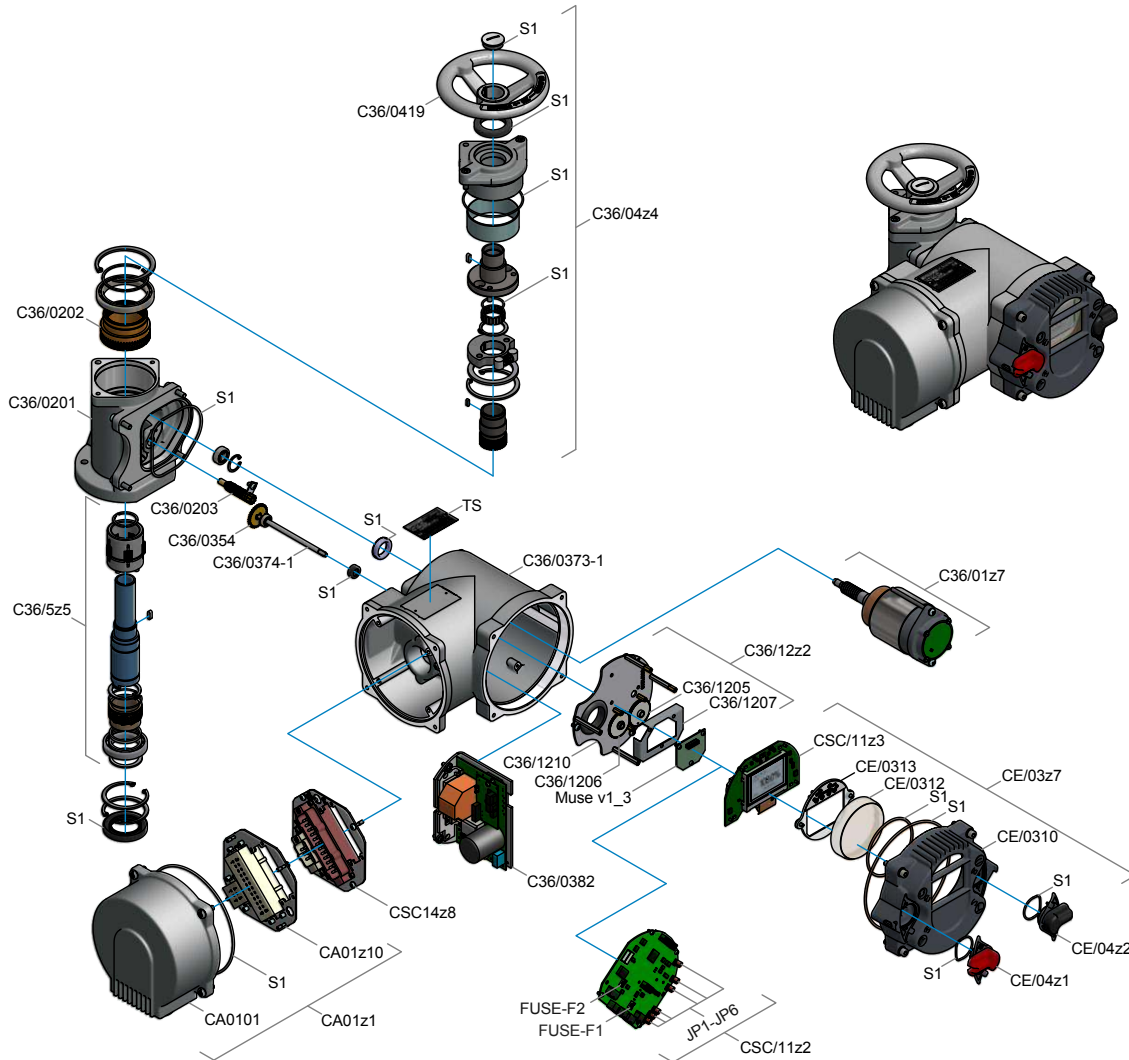
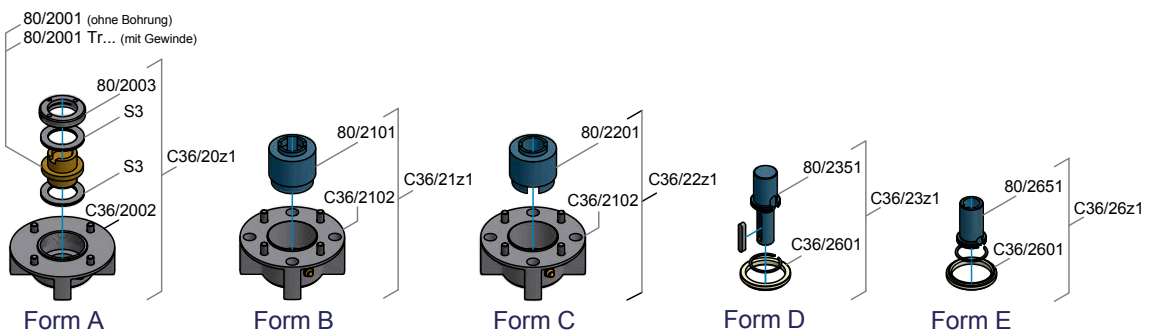
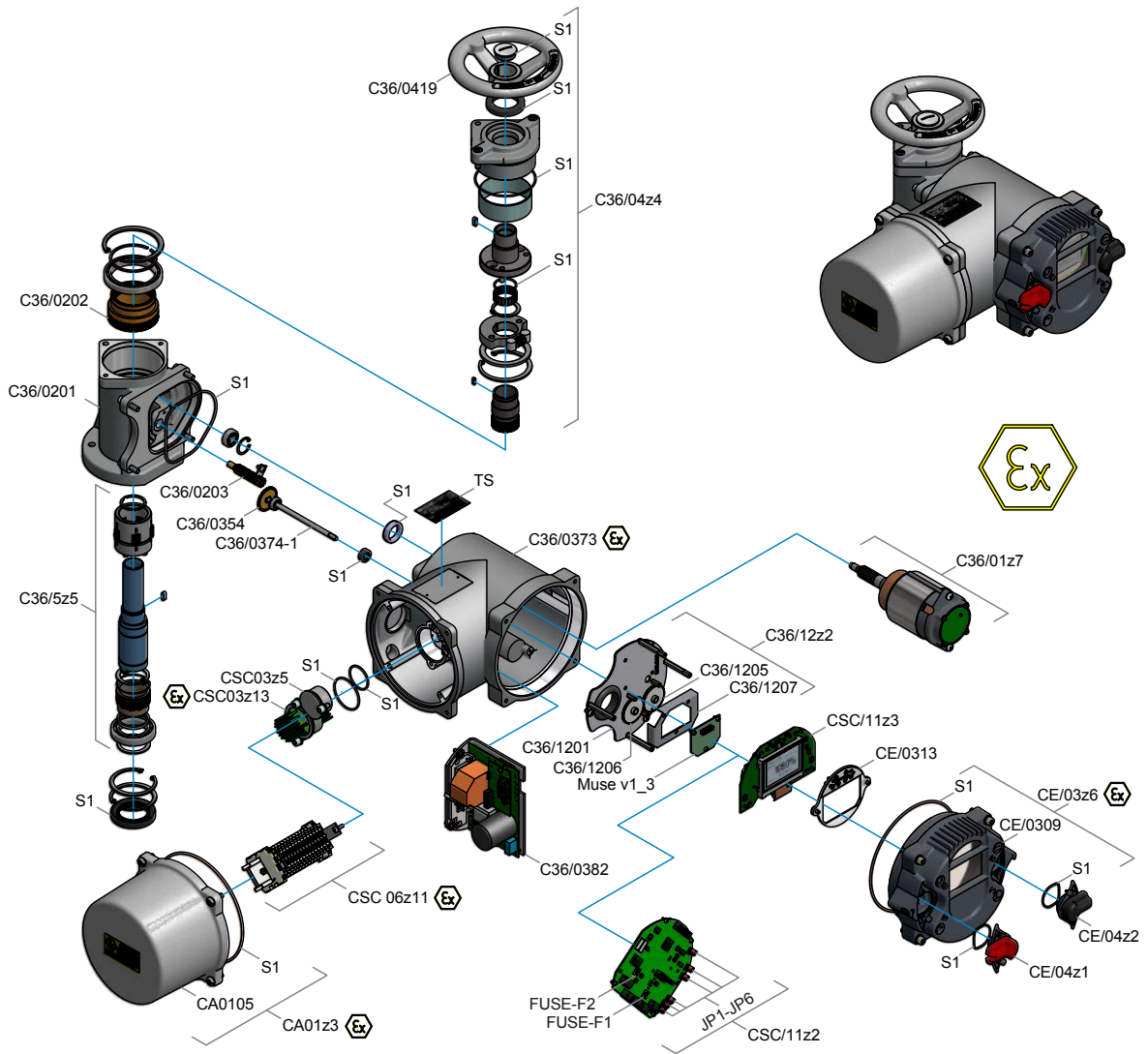

**CAUTION:** When ordering spare parts, you **must** provide the **serial number** (look type shield or status menu S6).

Use only original spare parts supplied by SCHIEBEL. Using other parts will render the warranty void. Illustrations may differ from actual spare parts.



No.	Description
CA01z1	Assembly A-Cover
CA01z10	Assembly insertable plate A-Cover-side
CA01z3	Assembly ex-A-cover
CE/03z6	Assembly ex-E-cover exCM with Display
CE/03z6o	Assembly ex-E-cover exCM
CE/03z7	Assembly E-cover CM with display
CE/03z7o	Assembly E-cover CM
CE04z1	Assembly switch red
CE04z2	Assembly switch black
CSC03z5	Dummy bushing LD34
CSC03z13	Cable bushing LD44
CSC06z11	Assembly ex-terminals
CSC/11z2	Logic
CSC/11z3	Display
CSC14z8	Assembly CM insertable plate actuator side
C36/01z7	Assembly motor
C36/0201	Housing CM03
C36/0202	Worm-wheel
C36/0203	Helical pinion
C36/0354	Gear
C36/0373	Housing-E exCM03
C36/0373-1	Housing-E CM03
C36/0374-1	Sensorshaft CM03
C36/0382	Assembly inverter
C36/12z2	Assembly partition with sensor
C36/12z2o	Assembly partition
C36/04z4	Assembly hand wheel CM03
C36/0419	hand wheel CM03
C36/05z5	Assembly spindle CM03
....	Assembly ball-bearing
FUSE-F1	Littelfuse 454 1A slow-blow
FUSE-F2	Littelfuse 454 4A slow-blow
Muse V1.3	Multiturnsensor
C304-1	Profibusprint DP1 1-channel
C304-2	Profibusprint DP2 2-channels
C314-1	Profibus connection board DP1 1-channel
C314-2	Profibus connection board DP2 2-channels

Nr.	Bezeichnung
C503	Nose cap M25x1.5
C503ex	ex-Nose cap M25x1.5
C601	Mounting plate for plugs control unit
C602	Plug Han24E male for signals control unit
C603	Plug Han6E male for power supply control unit
C608	Plug Profibus male control unit
C609	Frame for Plug Profibus control unit
C701	Mounting plate for plug customer site
C702	Plug Han24E female for signals customer site
C703	Plug Han6E female for power supply customer site
C708	Plug Profibus female customer site
C709	Frame for Plug Profibus customer site
80/2000	Spindle nut without thread
80/2001	Spindle nut with thread
80/2003	Ring nut
80/2004	Axial bearing set
80/2101	Socket "B"
80/2201	Claw coupling "C"
80/2351	Output shaft "D"
80/2651	Output shaft "E"
C36/2002	Flange type "A" and "Am"
C36/20z0	Assembly Output "A"
C36/20z1	Assembly Output "Am" - Spindle nut gebohrt
C36/2102	Flange type "B" und "C"
C36/21z1	Assembly Output "B"
C36/22z1	Assembly Output "C"
C36/23z1	Assembly Output "D"
C36/2601	Centring ring F07
C36/26z1	Assembly Output "E"
TS	Type label
S1	Sealing set
S2	Bearing set